

Halton Vita VSG – Exhaust grille



Overview

Halton Vita VSG is an exhaust grille for all Halton Vita OR Space and Halton Vita OR Zone solutions. It is an alternative to the Halton Vita VSC exhaust unit in designs where more flexibility in the placement of the exhaust is needed.

Application areas

- Operating rooms in hospitals
 - Halton Vita OR Space 5 solution
 - Halton Vita OR Space 7 solution

Key features

- Stainless steel exhaust air grilles equipped with a metal mesh fluff separator
- The stainless steel front panel is easy to remove and clean; can be sterilised in an autoclave

Dimensions and weight

The dimensions for the six exhaust grille sizes are detailed in the table.

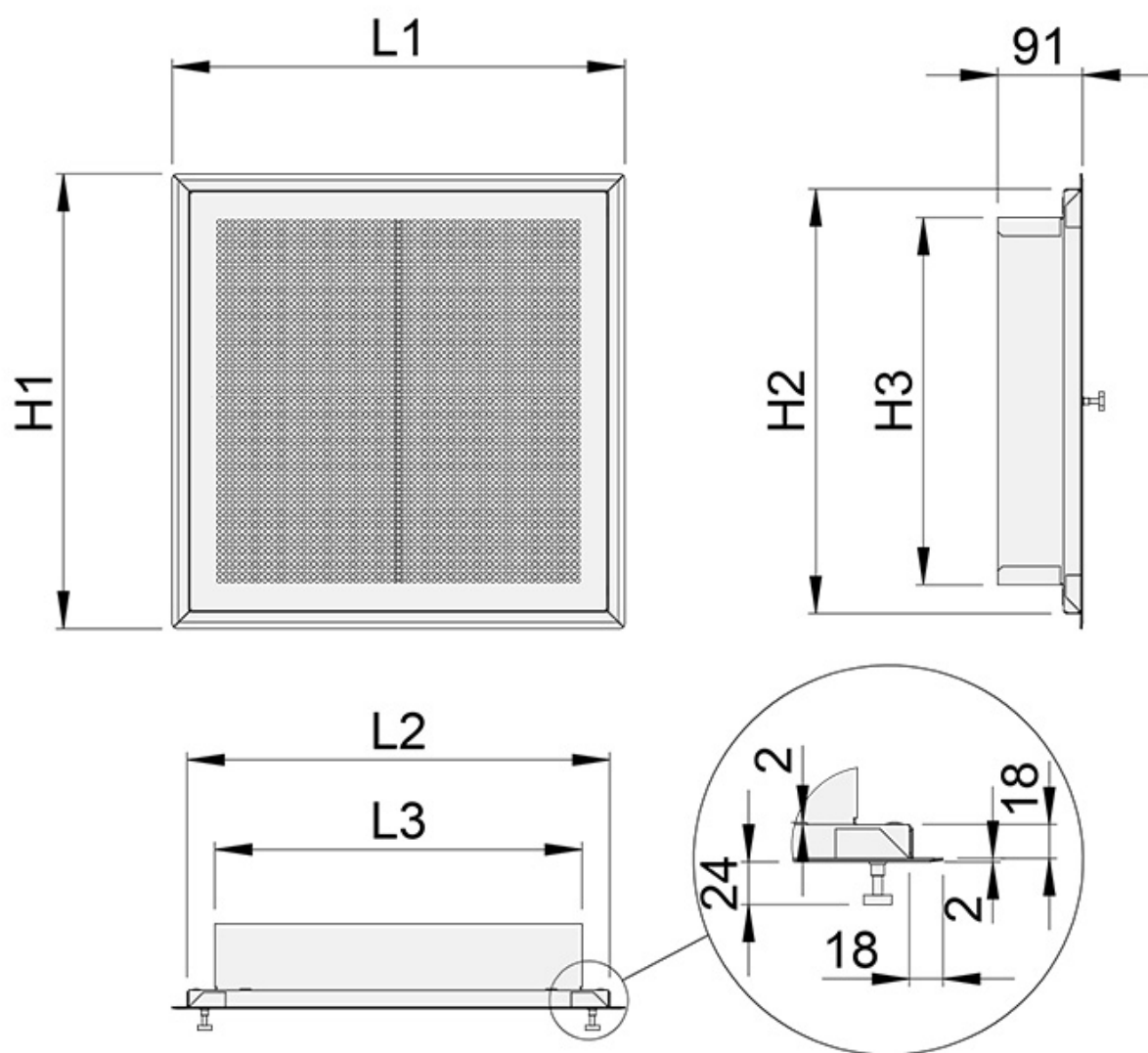

NS [mm]	L1 [mm]	L2 [mm]	L3 [mm]	H1 [mm]	H2 [mm]	H3 [mm]	Weight [kg]
400×200	487	456	395	287	256	195	6.5
400×400	487	456	395	487	456	395	9.0
500×250	587	556	495	337	306	245	8.0
500×500	587	556	495	587	556	495	11.0
600×250	687	656	595	337	306	245	9.0
600×600	687	656	595	687	656	595	13.5

Halton Vita VSG, frame dimensions

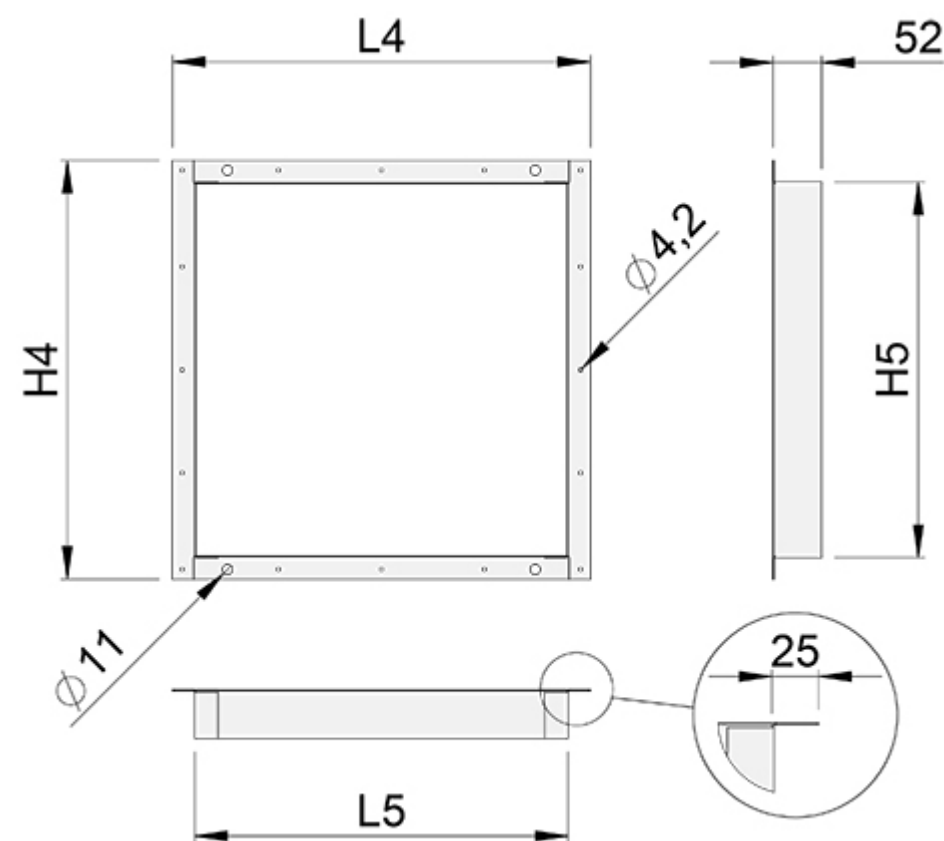

NS [mm]	L4 [mm]	L5 [mm]	H4 [mm]	H5 [mm]
400×200	447	399	247	201
400×400	447	399	447	401
500×250	547	499	297	251
500×500	547	499	547	501
600×250	647	599	297	251
600×600	647	599	647	601

Material

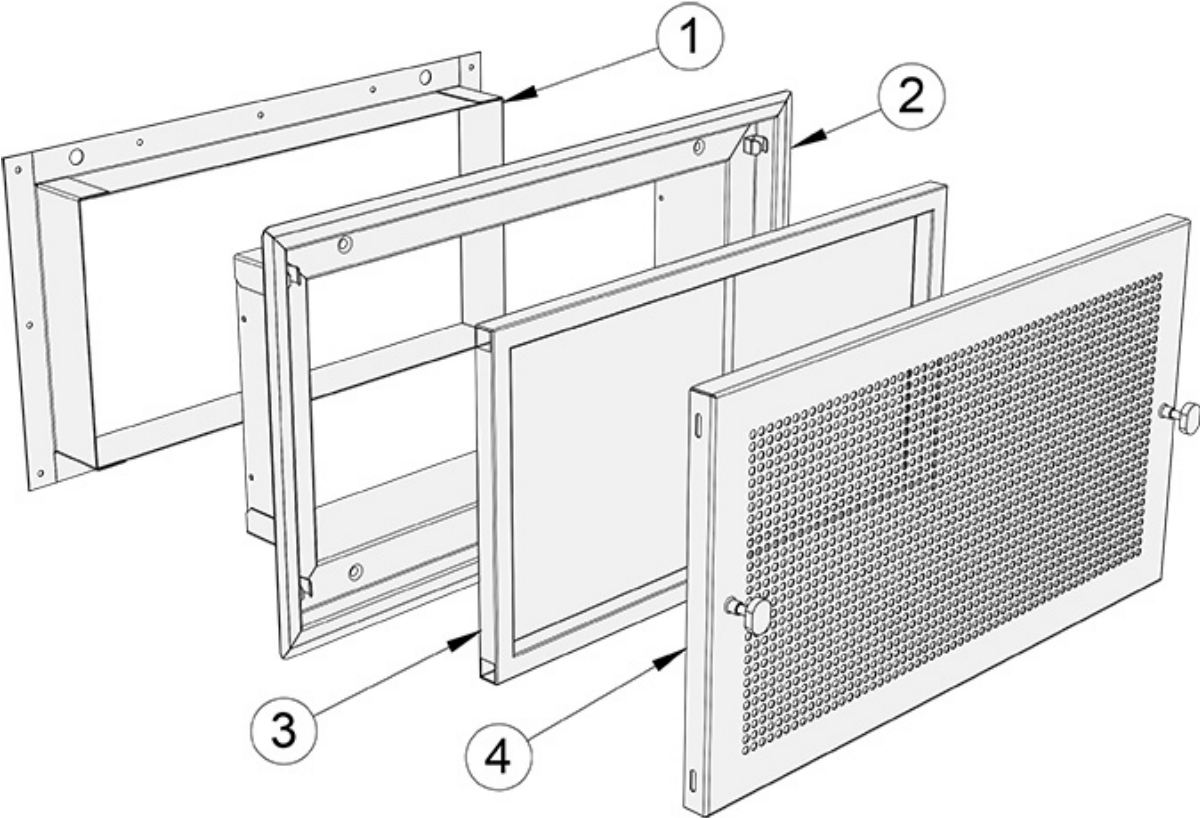

No.	Part	Material
1	Front panel	Stainless steel (AISI 316L)
2	Metal mesh fluff separator	Stainless steel (AISI 316L)
3	Frame for grille	Stainless steel (AISI 316L)
4	Fixing frame	Galvanised steel

Function

Air is exhausted from the space through the grille and the metal mesh fluff separator.

The purpose of the separator is to prevent fibre particles originating from the clothing of the personel and other operational textiles from entering the ventilation system.

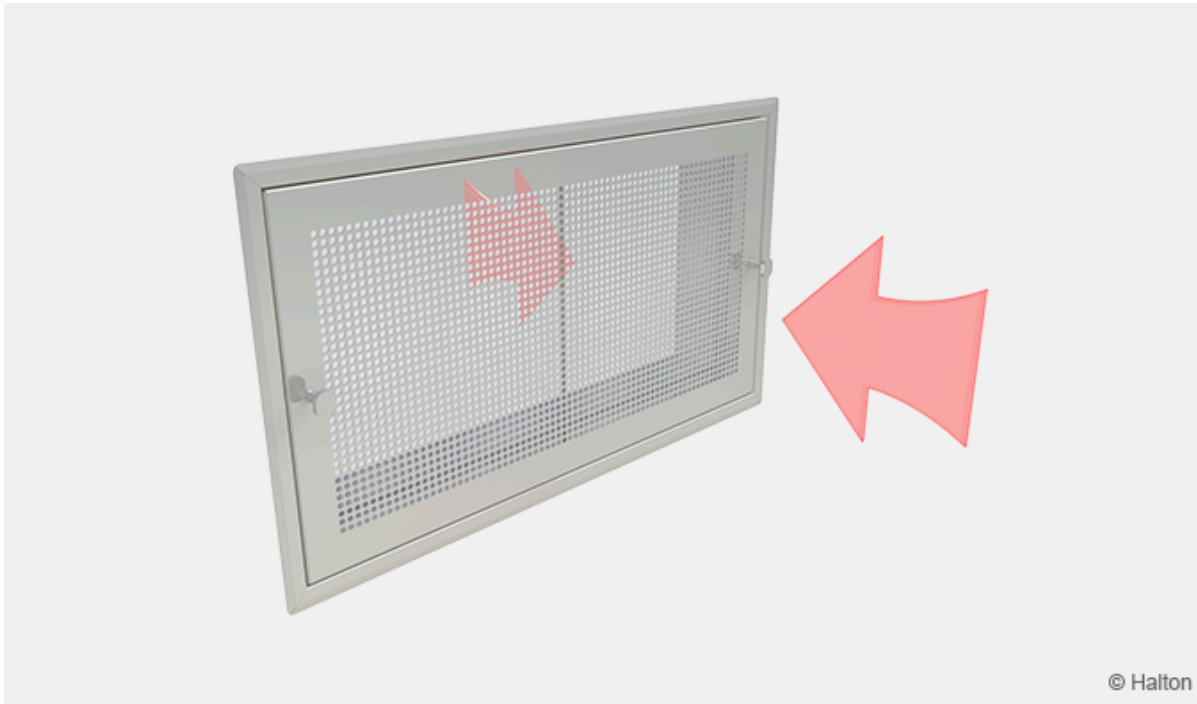

Filters

In the standard model, the exhaust grilles are equipped with stainless steel metal mesh fluff separators. The standard mesh size is 0.2 mm.

There are several exhaust grille options:

- Grilles with or without metal mesh filter
- Two grilles (bottom and top), or one grille (bottom)
- Painted or not painted duct

Note

Although the duct is painted it has to be covered with a wall construction.

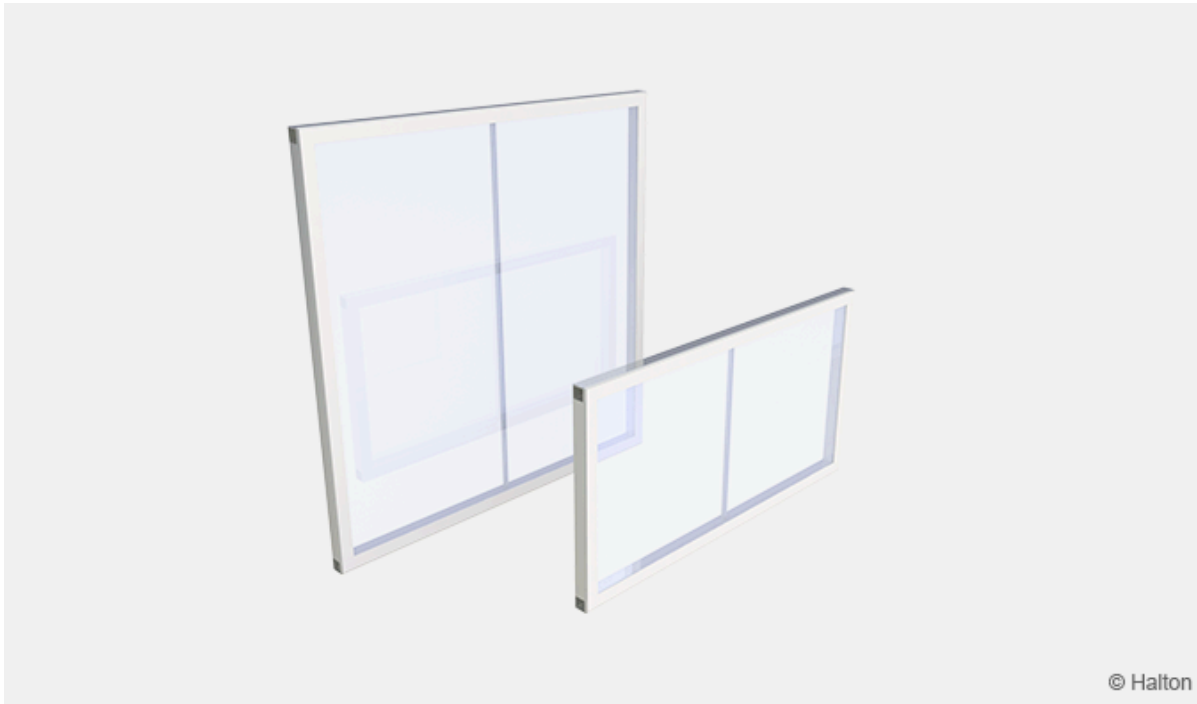

Fig.1. Metal mesh fluff separators

Installation

The exhaust grille is connected to the exhaust air ductwork. Wall or ceiling installations are possible.

The installation is typically performed by the ventilation contractor.

Note: See the sizes for the required installation holes from the Dimensions section. Step-by-step instructions on how to install Halton Vita VSG grille can be found in the Installation guide. See Downloads.

Servicing

Detach the perforated grille (2) by opening the screws (1). Wipe the grille with a damp cloth. Do not immerse in water.

The grille can also be sterilised in an autoclave ($t < 130^{\circ}$).

It is recommended to vacuum the metal mesh fluff separator (3) behind the grille regularly. It does not need to be removed for vacuuming.

Reassemble the grille and the screws.

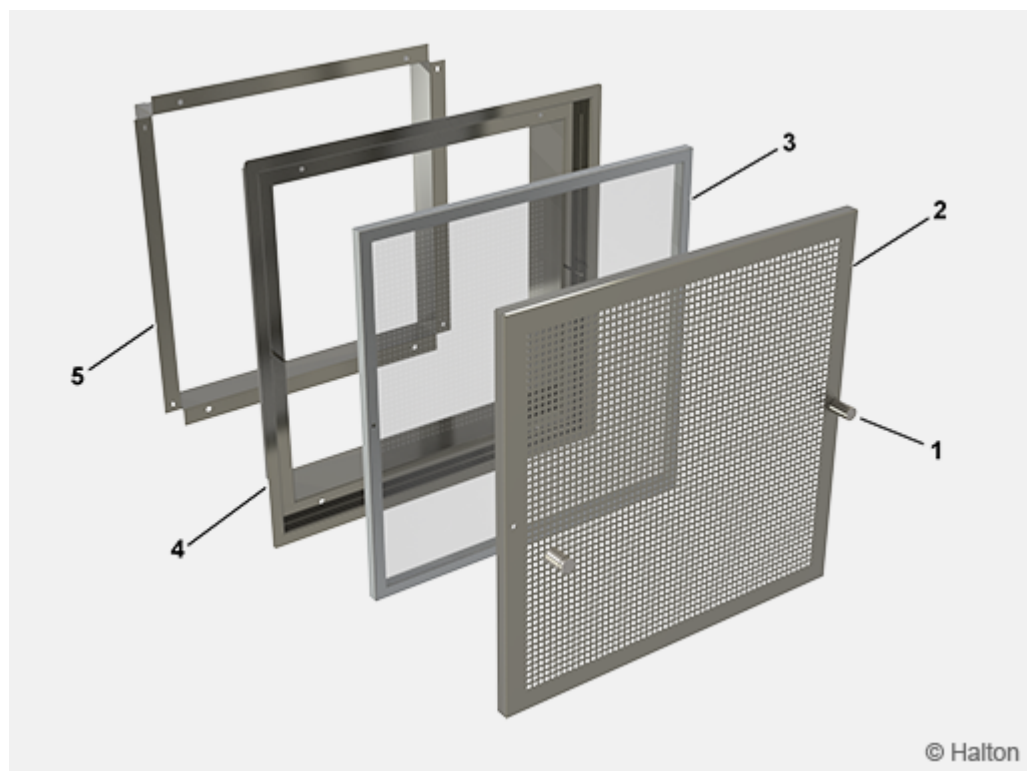

Key:

1. Screw (2 pcs)
2. Exhaust grille
3. Metal mesh fluff separator
4. Frame for grille
5. L-shape fixing bracket

Order code

VSG-W-H, AF-ZT

Main options	
W = Width [mm]	400, 500, 600
H = Height [mm]	200, 250, 400, 500, 600
Other options and accessories	
AF= Air filter	
A	Metal mesh fluff separator (stainless steel, AISI 316)
N	No filter
ZT = Tailored product	
N	No
Y	Yes (ETO)

Order code example

VSG-400-200,AF=A, ZT=N